

# LED CANOPY LIGHT - LEGACY™ DOUBLE DECK (CRUS - DDM)



For Use on Water-tight Plenum Canopies

US & Int'l. patents pending.

**HOUSING** - Low profile, durable die-cast, aluminum construction, providing a reliable weather-tight seal.

**LEDS** - Features an array of select, mid-power, high brightness, high efficiency LED chips; 5000K color temperature, 70 CRI (nominal).

**DRIVE CURRENT** - Choice of Very Low Wattage (VLW), Low Wattage (LW), Super Saver (SS), High Output (HO) or Very High Output (VHO).

**OPTICS / DISTRIBUTION** - Symmetrical, which directs light through a clear tempered glass lens, to provide a uniform distribution of light to vertical and horizontal surfaces.

**OPTICAL UNIT** - Features an ultra-slim 7/8" profile die cast housing, with a standard flat glass lens. Unit is water-resistant, sealed to an IP67 rating. Integral designed heat sink does not trap dirt and grime, ensuring cool running performance over the life of the fixture.

**PRESSURE STABILIZING VENT** - Luminaire assembly incorporates a pressure stabilizing vent breather to prevent seal fatigue and failure.

**HAZARDOUS LOCATION** - Designed for lighter than air fuel applications. Product is suitable for Domestic Class 1 Division 2, only when properly installed per LSI installation instructions (consult factory).

**DRIVER** - State-of-the-art driver technology superior energy-efficiency and optimum light output. Driver components are fully encased in potting for moisture resistance. Complies with IEC and FCC standards. 0-10 V dimming supplied standard with all drive currents.

**DRIVER HOUSING** - Die cast aluminum, wet location rated driver/electrical enclosure is elevated above canopy deck to prevent water entry, provide easy "knock-out" connection of primary wiring and contributes to attaining the lowest operating temperatures available. Seals to optical housing via one-piece molded silicone gasket.

**OPERATING TEMPERATURE** - -40°C to 50°C (-40°F to +122°F)

**ELECTRICAL** - Universal voltage power supply, 120-277 VAC, 50/60 HZ input. Drivers feature two-stage surge protection (including separate surge protection built into electronic driver) meets IEEE C62.41.2-2002, Scenario 1, Location Category C.

**FINISH** - Standard color is white and is finished with LSI's DuraGrip polyester powder coat process. DuraGrip withstands extreme weather changes without cracking or peeling.

**INSTALLATION** - One person installation. No additional sealant required. Installs in a 12" or 16" deck pan. Deck penetration consists of a 11" square hole. Fixture is secured via 4 fasteners directly through frame and deck into structure members/beams.

**SHIPPING WEIGHT** - 22 pounds.

**EXPECTED LIFE** - Minimum 60,000 to 100,000 hours depending upon the ambient temperature of the installation location. See LSI web site for specific guidance.

**WARRANTY** - Limited 5-year warranty.

**LISTING** - UL and ETL listed to UL 1598, UL 8750 and other U.S. and International safety standards. Suitable for damp locations.

**PHOTOMETRICS** - Applications layouts are available upon request. Contact LSI Petroleum Lighting or petroleum.apps@lsi-industries.com.

This product, or selected versions of this product, meet the standards listed below. Please consult factory for your specific requirements.



IP67



Project Name \_\_\_\_\_ Fixture Type \_\_\_\_\_

Catalog # \_\_\_\_\_

7/22/19

© 2017  
LSI INDUSTRIES INC.

# LED CANOPY LIGHT - LEGACY™ DOUBLE DECK (CRUS - DDM)

## LUMINAIRE ORDERING INFORMATION

TYPICAL ORDER EXAMPLE: **CRUS DDM SC LED SS 50 UE WHT**

Prefix	Distribution	Light Source	Drive Current	Color Temperature	Input Voltage	Finish
CRUS DDM	SC - Standard Symmetric	LED	VLW - Very Low Watt LW - Low Watt SS - Super Saver HO - High Output VHO - Very High Output	50 - 5000K	UE - Universal Voltage (120-277V)  347 - 347V	WHT - White BRZ - Bronze BLK - Black

## DIMENSIONS

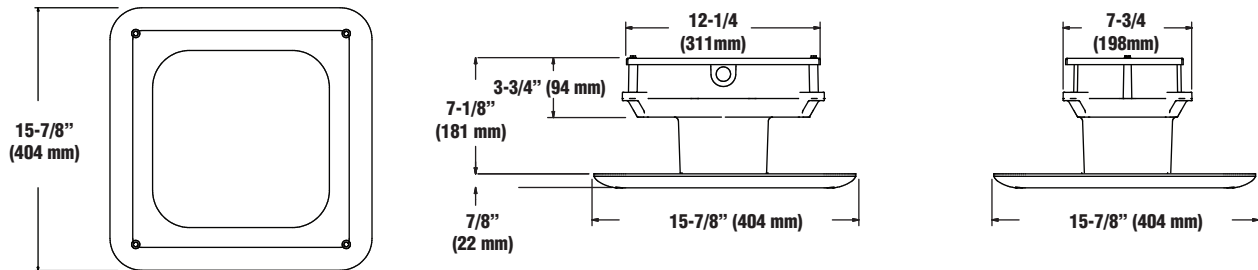

## LIGHT OUTPUT - CRUS DDM

		Lumens		Watts	LPW	
		SC	AC	SC/AC	SC	AC
Cool White	VLW - Very Low Watt	9055	7632	61	148	125
	LW - Low Watt	10525	8884	74	142	120
	SS - Super Saver	13674	11595	98	140	118
	HO - High Output	18633	15145	132	141	115
	VHO - Very High Output	22418	17262	159	141	109



Project Name \_\_\_\_\_ Fixture Type \_\_\_\_\_  
Catalog # \_\_\_\_\_