

INSTALLATION AND ASSEMBLY INSTRUCTIONS

XHB3 Series Featuring TriLume® Optics

SAVE THESE INSTRUCTIONS AND DELIVER TO OWNER AFTER INSTALLATION

BEFORE YOU BEGIN



Read these instructions completely and carefully, observing all CAUTIONS and WARNINGS shown throughout these instructions.

WARNING! RISK OF ELECTRIC SHOCK

- Disconnect or turn off power before installation or servicing.
- Verify that supply voltage is correct by comparing it with the luminaire label information.
- Make all electrical and grounded connections in accordance with the National Electrical Code (NEC) and any applicable local code requirements.

CAUTION: RISK OF INJURY

- Wear gloves and safety glasses at all times when removing luminaire from carton, installing, servicing or performing maintenance.
- Allow luminaire/driver to cool before handling.

NOTICE: RISK OF PRODUCT DAMAGE- Failure to follow instructions could result in damage to product and void ALL warranties!

- Install fixture only in dry locations.
- Do NOT connect components under load.
- Do NOT mount or support these fixtures in a manner that can cut the outer wire jacket or damage wire insulation.
- Do NOT restrict fixture ventilation. Allow for some volume of airspace around fixture. Avoid covering LED fixtures with insulation, foam or other material that will prevent convection or conduction cooling.
- Do NOT exceed fixtures maximum ambient temperature rating.
- Do NOT install outdoors.

CLEANING INSTRUCTIONS

Occasional cleaning may be necessary to ensure top performance of the luminaire.

- Frequency of cleaning will depend on environmental conditions and the light output level that is acceptable to the user.
- To Clean: wipe lens with a DAMP cloth. Use only a solution of warm water and a mild, non-abrasive household detergent. Dry with soft, dry, clean cloth.
- Do NOT use chemical cleaners such as powder cleansers, bleach, etc.
- Do NOT use scouring pads, as this will scratch and damage the lens finish.
- Do NOT wipe with a soiled cloth or wet towel - these may leave a residue that can damage finish.
- Do NOT pressure wash or use hose to clean luminaire.
- Do NOT immerse in water.



XHB3 Series Featuring TriLume® Optics, cont'd.

WARNING: Disconnect power before servicing. Risk of fire or electrical shock.
WARNING: All wiring to be performed by qualified electrician to National Electrical Code and local code.

IMPORTANT: Do NOT connect to live loads!

NOTICE: Failure to follow instructions could result in damage to product and void ALL warranties!

FOR HOOK INSTALLATIONS, SEE BELOW. FOR PENDANT INSTALLATIONS, SEE PAGE 4.

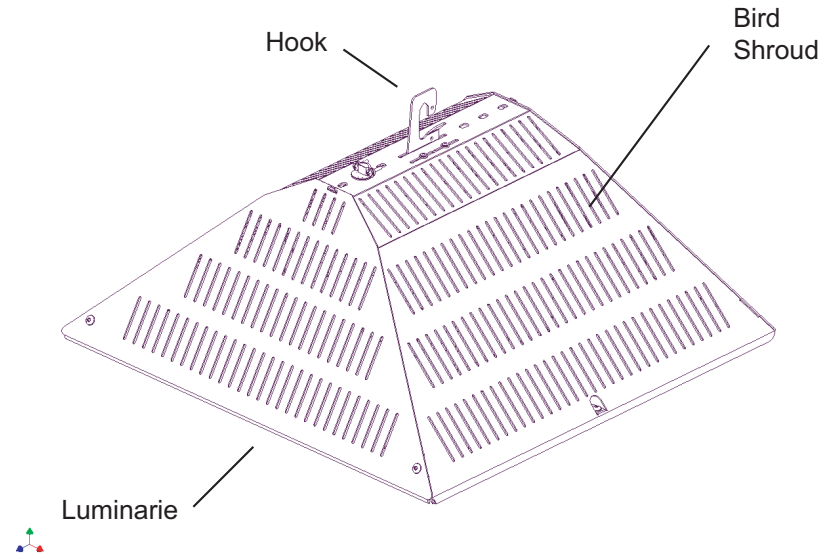

1. Reference layout drawing for luminaire placement
2. A suitable eyebolt reliably secured and square to ceiling is recommended for installation using hook. Insert hook thru eyebolt to hang luminaire. Take care when installing eyebolt to ensure desired luminaire orientation.

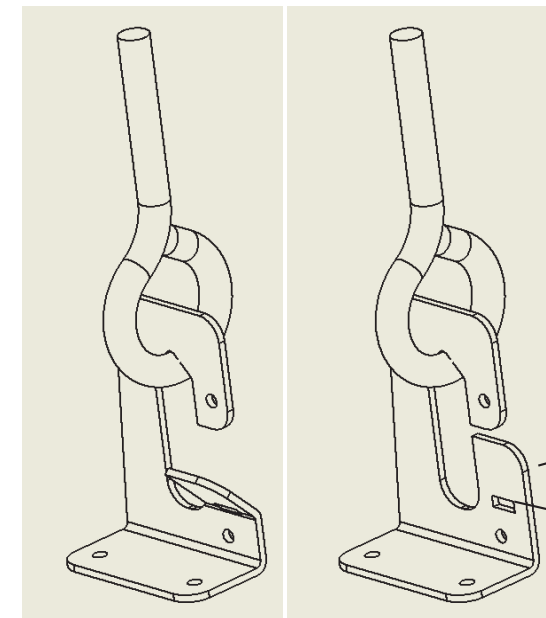

BEFORE

AFTER

3. Insert flat blade screwdriver into hook safety slot; bend upwards.

Hook safety flange bent upward

Safety slot



Crossover® XHB3 Series, cont'd.

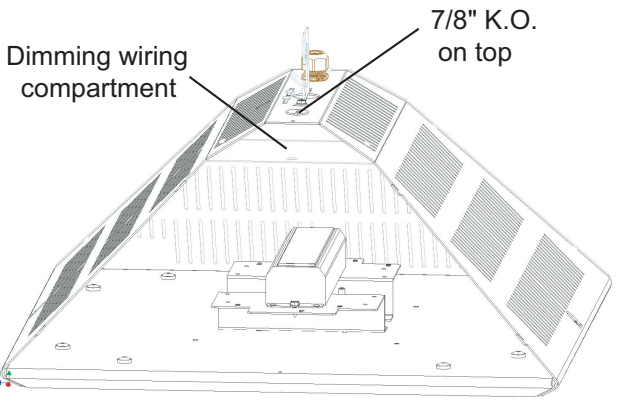
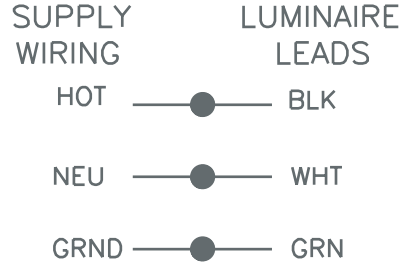

End Panel Removed

- Make necessary supply wiring connections to supplied Luminaire leads using appropriate wire connectors. **WARNING: Risk of electrical shock. Make certain supply wiring is not "hot" before wiring. Luminaires are marked for specific voltage! "UE" luminaires are universal voltage 120 - 277VAC, 50/60Hz. 347-480V marked luminaires can be connected to 347-480V, 50/60Hz.**

NOTE: If installing with 0-10V dimming option, remove side panel screw nearest to the 7/8 " knock out. Slide the end panel up to disengage the locking tabs, remove the panel and set aside. Remove the knockout plug by inserting a flat blade screw driver. Place an appropriate wire clamp in the 7/8 " knock out hole and secure. Run 0-10V dimming control wire thru the wire clamp and into the dimming wire enclosure. Connect the control wires to the violet and gray driver wires using the supplied lever connectors. Push all dimmer wire lengths into enclosure to ensure no pinching of wires will occur. Tighten wire clamp around dimming control wires. Replace side panel and fasten with 1-screw at top.

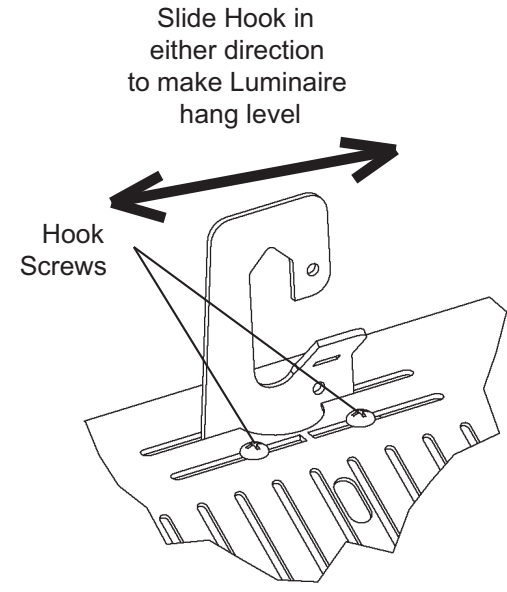

- If luminaire does NOT hang evenly, hook position can be adjusted to hang luminaire level. Loosen both hook screws then slide hook into a level position. Tighten both screws.
- This completes Hook Mount installation.

Installation Questions?
 Call LSI Field Service Department at:
 1-800-436-7800 Ext. 3300
 Fax: 1-877-861-1368

Crossover® XHB3 Series, cont'd.

PENDANT MOUNT INSTALLATIONS ONLY

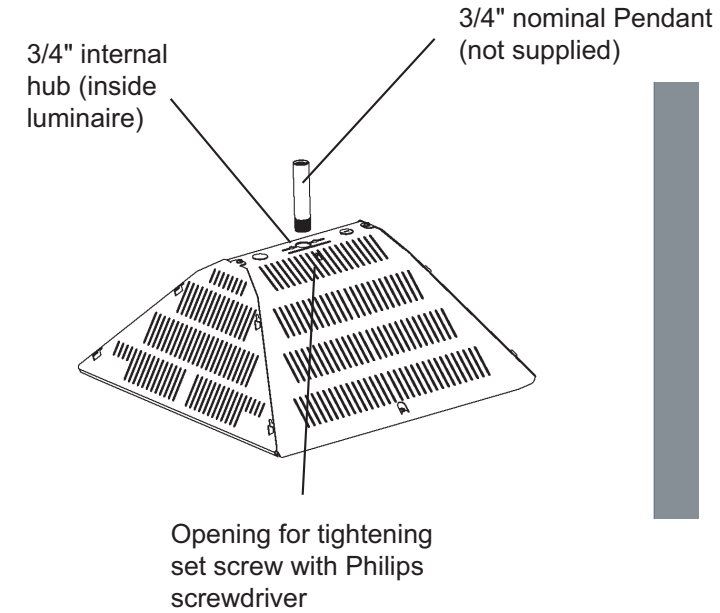

- Feed luminaire conductors thru 3/4" nominal Pendant (not supplied). Thread Pendant into center internal hub. Tighten Pendant to hub. When tight, further secure Pendant to luminaire with set screw. Use Philips screwdriver to tighten set screw.

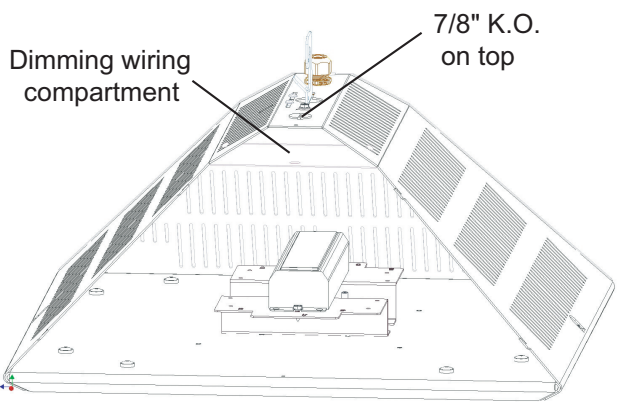
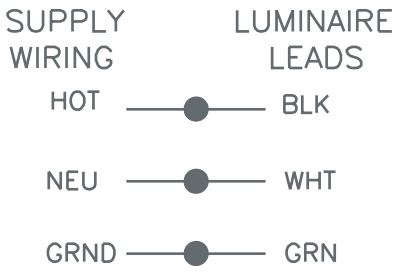

End Panel Removed

- Make necessary supply wiring connections to supplied luminaire leads using appropriate wire connectors. **WARNING: Risk of electrical shock. Make certain supply wiring is not "hot" before wiring. Luminaires are marked for specific voltage! "UE" luminaires are universal voltage 120 - 277VAC, 50/60Hz. 347-480V marked luminaires can be connected to 347-480V, 50/60Hz.**

NOTE: If installing with 0-10V dimming option, remove side panel screw nearest to the 7/8 " knock out. Slide the end panel up to disengage the locking tabs, remove the panel and set aside. Remove the knockout plug by inserting a flat blade screw driver. Place an appropriate wire clamp in the 7/8 " knock out hole and secure. Run 0-10V dimming control wire thru the wire clamp and into the dimming wire enclosure. Connect the control wires to the violet and gray driver wires using the supplied lever connectors. Push all dimmer wire lengths into enclosure to ensure no pinching of wires will occur. Tighten wire clamp around dimming control wires. Replace side panel and fasten with 1-screw at top.

- This completes Pendant Mount installation.