



1x4 LPASC

Low Profile Recessed Troffer



OVERVIEW	
Lumen Range (lm)	1,950 - 8,300
CCT (K)	3000, 3500, 4000, 5000 Tunable White
Wattage Range (W)	16- 63
Efficacy Range (LPW)	119 - 139
Weight lbs (kg)	14.5 (6.6)

QUICK LINKS

[Ordering Guide](#)[Performance](#)[Photometrics](#)[Dimensions](#)

FEATURES & SPECIFICATIONS

Construction

- Rigid housing is die-formed 22-gauge cold-rolled steel for consistency and strength.
- Luminaire comes equipped with integral NEC-compliant earthquake clips.
- Ultra-slim (< 4") luminaire height and light-weight design effectively targets a broad range of plenum/wall spaces and allows for easy installation.
- Thermally optimized housing allows for direct insulation contact (IC rated).
- Luminaire is treated with phosphate rust inhibitor prior to powder coating. Reflecting surfaces are coated with high-reflectance (minimum 92%) white polyester powder.
- Luminaire is proudly manufactured in the U.S.A

Optical System

- High-transmission diffuse acrylic radial lens eliminates bright spots from individual LEDs and provides high vertical illuminance and visual comfort.
- Tunable White with digital control option with a CCT range of 2700K - 6500K
- State of the art LED chips for reliability and extended lumen maintenance

Electrical

- High-performance driver features over-voltage, under-voltage, short-circuit and over temperature protection.
- 0-10V dimming (1% - 100%) standard.
- Standard Universal Voltage (120-277 VAC)

or optional High Voltage (347 VAC) 50/60 Hz input.

- L80 Calculated Life: >100k Hours (See lumen maintenance table on Page 3)
- Total harmonic distortion (THD): <20%
- Power factor: > 0.95
- Sensor-ready drivers available; consult factory for details.
- Optional 120-277VAC integral emergency battery backup is available to meet critical life-safety standby lighting requirements. A test switch/indicator button is installed in the housing for ease of visibility and maintenance.

Controls

- Tunable White powered by LSI AirLink™ Blue offers wireless digital CCT tuning between 2700K and 6500K. Tunable White technology provides ultimate flexibility and control to the end user and future-proofs any space. LSI's tried and tested AirLink™ Blue interface makes it the simplest yet most powerful system in its class. With additional capabilities for grouping, zoning and scene controls, the system can be combined with occupancy sensing and daylight harvesting to maximize energy savings and meet applicable code.
- Stand-alone integral passive infrared sensor (IMS1) enables motion and daylight sensing. Optional IR remote (REM-SOLO) makes configuration changes easy.
- LSI AirLink™ controls featuring Lutron Clear Connect makes each luminaire controllable, creating a wireless communication network

with other AirLink™ control devices such as dimmers, switches, occupancy sensors and photocontrols. The integrated sensor is both a passive infrared motion detector and daylight harvester.

Installation

- Luminaire installs by lifting it through grid ceiling and resting it on the T-bars.
- Luminaire installs onto standard 15/16" and narrow 9/16" T-grid ceiling systems.
- An accessory flange kit is available for installing into drywall or plaster.

Warranty

- LSI luminaires carry a 5-year limited warranty. Refer to <https://www.lsiindustries.com/resources/terms-and-warranty.aspx> for more information.

Listings

- Listed to UL(R) 1598 and UL(R) 8750.
- DesignLights Consortium® (DLC) Premium and/or standard. Not all versions of this product may be DLC listed. Please check the DLC Qualified Products List at www.designlights.org/QPL to confirm which SKUs are listed.
- Meets Buy American Act (BAA) requirements.
- Title 24 Compliant; see local ordinance for qualification information.
- IC Rated for direct contact with building insulation.
- Suitable For Damp Locations.





1x4 LPASC Low Profile Recessed Troffer

ORDERING GUIDE

[Back to Quick Links](#)TYPICAL ORDER EXAMPLE: **LPASC14 LED 75L UNV DIM1 TW ALBC U**

Family/Size	LED Gen	Lumen Package*	Voltage	Driver	Color Temperature	Controls	Options	Packaging
LPAS14 - (1x4)	LED	20L - 2,000	UNV - 120-277VAC HV - 347VAC ¹	DIM1 - Dims to 1% (0-10 volt dimming) ¹	30 - 3000K ^{3,4}	BLANK - (No Controls)	EM10- 10 Watt Emergency Battery Backup	U - Single Pack
		25L - 2,500						
		32L - 3,200			35 - 3500K			
		38L - 3,800			40 - 4000K			
		45L - 4,500		LDE1 - Hi-Lume 1% (with Soft on Fade to Black) ³	50 - 5000K		FC1 - 6' 3/8" (3) #18 Leads (For use in Non-Dimming Applications)	
		50L - 5,000		L3D - Lutron Hi-Lume 1% ¹		ALDCS - AirLink/Lutron Integral Fixture Control with motion and daylighting sensing	FC15D - 6' 3/8" (5) #18 Leads (For use in Dimming Applications)	
		55L - 5,500		LDE5 - Lutron 5-Series ¹		ALDC - AirLink/Lutron Integral Fixture Control (RF only)	FC16DEM - 6' 3/8" (6) #18 Leads (For use in Dimming & EM Applications)	
		65L - 6,500		SR - Sensor Ready ^{3,5}			90C - 90 CRI ^{3,4}	
		70L - 7,000						
		75L - 7,500						
		80L - 8,000						
		Custom Lumen Packages ⁶						
LPASC14 - (1x4)	LED	75L - 7,500	UNV - 120-277VAC	DIM1 - Dims to 1% (0-10 volt dimming) ¹	TW ^{1,7} - Tunable White	ALBC ⁷	90C - 90 CRI ^{3,4}	U - Single Pack

Accessory Ordering Information

Description	Order Number
Flange Kit 1x4	FK14
IR remote configuration tool for IMS1	REM-SOLO

Integral PIR Motion and Daylight Sensor (IMS1)

Low profile sensor provides bi-level control based on motion and/or daylight. All control parameters are adjustable using the IR remote (sold separately).

[Click here to learn more about IMS1](#)

FOOTNOTES:

- 1- Not available with ALDCS Control option.
- 2- Consult factory for other colors.
- 3- Consult Factory for lead times.
- 4- Consult factory for DLC qualification information.
- 5- Required with ALDCS Control option.
- 6- Custom lumen packages available, please consult factory. Values are within industry standard tolerances and not DLC listed.
- 7- Only available with 120-277VAC input.

AirLink™ Control Accessories Order as separate catalog number.

Wireless switches	Catalog number	Part Number	Wireless Occupancy Sensors	Part Number
On/Off & Raise Lower	ALWS 3B-(color)-KIT ²	6241032	Wireless 360° 400 ft², Ceiling Mount	624094
			Wireless 180° 3000 ft², Wall Mount	632617
Wireless Photocell controls	ALCM-W-PC	624090	Wireless 90° 2500 ft², Corner Mount	624096
			Wireless, Halfway 150 ft Length	632620
Commission Laser Kit				
(See Laser warnings)		634574		





1x4 LPASC Low Profile Recessed Troffer

PERFORMANCE

[Back to Quick Links](#)

DELIVERED LUMENS									
Lumen Package	3000K CCT		3500K CCT		4000K CCT		5000K CCT		Wattage
	Delivered Lumens	Efficacy	Delivered Lumens	Efficacy	Delivered Lumens	Efficacy	Delivered Lumens	Efficacy	
20L	1946	119.4	1963	120.4	2018	123.8	2152	132.0	16.3
25L	2435	120.0	2457	121.0	2526	124.4	2694	132.7	20.3
30L	2892	120.5	2918	121.6	3000	125.0	3199	133.3	24.0
35L	3381	119.9	3411	121.0	3507	124.4	3740	132.6	28.2
40L	3890	119.0	3925	120.0	4035	123.4	4303	131.6	32.7
45L	4358	125.6	4397	126.7	4520	130.3	4820	138.9	34.7
50L	4887	124.0	4931	125.1	5069	128.7	5406	137.2	39.4
55L	5373	123.5	5421	124.6	5573	128.1	5943	136.6	43.5
60L	5794	122.5	5846	123.6	6010	127.1	6409	135.5	47.3
65L	6284	122.3	6340	123.4	6518	126.8	6951	135.2	51.4
70L	6819	120.5	6880	121.6	7073	125.0	7543	133.3	56.6
75L	7280	119.7	7345	120.8	7551	124.2	8052	132.4	60.8
80L	7510	118.5	7578	119.5	7790	122.9	8307	131.0	63.4

*LED Chips are frequently updated therefore values are nominal.

ELECTRICAL DATA*							
Lumens	Watts	120V	208V	240V	277V	347V	
20L	16.3	0.136	0.078	0.068	0.059	0.047	
25L	20.3	0.169	0.098	0.085	0.073	0.059	
30L	24.0	0.200	0.115	0.100	0.087	0.069	
35L	28.2	0.235	0.136	0.118	0.102	0.081	
40L	32.7	0.273	0.157	0.136	0.118	0.094	
45L	34.7	0.289	0.167	0.145	0.125	0.100	
50L	39.4	0.328	0.189	0.164	0.142	0.114	
55L	43.5	0.363	0.209	0.181	0.157	0.125	
60L	47.3	0.394	0.227	0.197	0.171	0.136	
65L	51.4	0.428	0.247	0.214	0.186	0.148	
70L	56.6	0.472	0.272	0.236	0.204	0.163	
75L	60.8	0.507	0.292	0.253	0.219	0.175	
80L	63.4	0.528	0.305	0.264	0.229	0.183	

ELECTRICAL DATA* - TUNABLE WHITE					
Lumens	Watts	120V	208V	240V	277V
75L	63	0.53	0.30	0.26	0.23

*Electrical data at 25C (77F). Actual wattage may differ by +/-10%.

SCALING FACTORS - TUNABLE WHITE		
CCT	Lumens	Wattage
2700K	0.95	1.05
3000K	0.97	1.02
3500K	0.99	1.01
4000K	1.00	1.00
5000K	1.00	1.01
6500K	0.98	1.05

RECOMMENDED LUMEN MAINTENANCE ¹					
Ambient Temp C	0 hrs. ²	25K hrs. ²	50K hrs. ³	75K hrs. ³	100K hrs. ³
25	100%	94.49%	91.48%	88.47%	85.56%

RECOMMENDED LUMEN MAINTENANCE ¹ - TUNABLE WHITE					
Ambient Temp C	0 hrs. ²	25K hrs. ²	50K hrs. ³	75K hrs. ³	100K hrs. ³
25	100%	95%	91%	87%	83%

1 - Lumen maintenance values at 25°C are calculated per TM-21 based on LM-80 data and in-situ luminaire testing.

2 - In accordance with IESNA TM-21-11, Projected Values represent interpolated value based on time durations that are

within six times (6X) the IESNA LM-80-08 total test duration (in hours) for the device under testing ((DUT) i.e. the packaged LED chip).

3 - In accordance with IESNA TM-21-11, Calculated Values

represent time durations that exceed six times NA LM-80-08 total test duration (in hours) for the device under testing ((DUT) i.e. the packaged LED chip).





1x4 LPASC Low Profile Recessed Troffer

PHOTOMETRICS

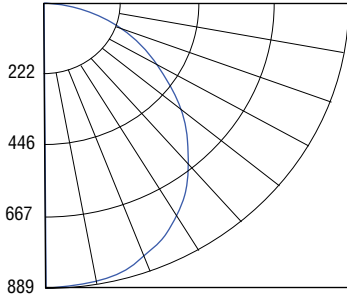
[Back to Quick Links](#)

LPASC14 LED 30L 40

Luminaire photometry has been conducted by a NVLAP accredited testing laboratory in accordance with IESNA LM-79-08. As specified by IESNA LM-79-08 the entire luminaire is tested as the source resulting in a luminaire efficiency of 100%.

See <http://www.lsi-industries.com/products/led-lighting-solutions.aspx> for detailed photometric data.

ZONAL LUMEN SUMMARY

Zone	Lumens	% Luminaire
0-20	327.6	10.8
0-30	712.9	23.5
0-40	1,199.4	39.6
0-60	2,242.9	74.0
0-80	2,945.6	97.2
0-90	3,030.7	100.0
10-90	2,947.5	97.3
20-40	871.7	28.8
20-50	1,403.4	46.3
40-70	1,468.7	48.5
60-80	702.7	23.2
70-80	277.5	9.2
80-90	85.1	2.8
90-180	0.0	0
0-180	3,030.7	100.0

PRODUCT DIMENSIONS

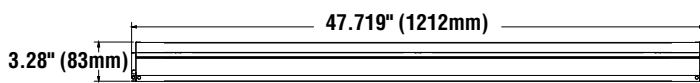
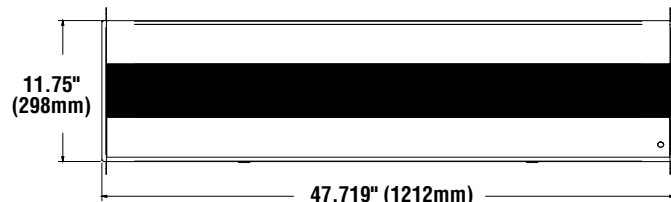
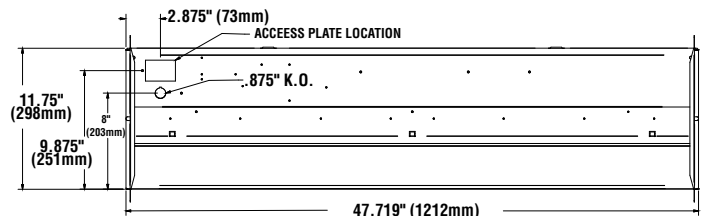
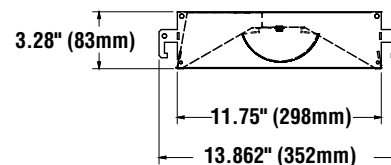
[Back to Quick Links](#)**SIDE VIEW****TOP VIEW****BACK VIEW****END VIEW**